

Guest Room Information

Number of Floors	4	
Number of Rooms	306	
Configuration of Rooms	100 Deluxe Jacuzzi	King Bed
	64 Deluxe Pool View	Twin Bed
	27 Deluxe Plunge Pool	King/Twin connecting rooms
	46 Grand Deluxe Jacuzzi	King Bed
	62 Grand Deluxe Pool View	Twin Bed
	7 Suites	King Bed
Guest Room Facilities	Each room comes with an balcony, central air-conditioning with individual controls, 39" LCD TV with cable/satellite channels, NDD/IDD telephone, free high-speed Wi-Fi internet access, coffee and tea making facilities, mini refrigerator, 14" laptop size safety deposit box, slippers, bathroom amenities, integrated multiplug and electronic door lock.	

Guest Services & Recreation Facilities

Restaurant	Swimming Pool
Pool Bar	Fitness Centre
Meeting Rooms with daylight	Resort Shop
Airport Transfer	24-hours In-Room Dining
Parking Space	24-hours Security and CCTV
Spa	Concierge Service
Laundry and Dry-Cleaning Service	Babysitting



Destination Information



Located in the heart of Sanur Beach Village (5 minutes to Starbucks)

In the middle of stylish boutiques, smart dining, relaxing Day-Spas, Bars with live music

A short 8 minutes stroll to Sanur Beach

Just a 30-minute drive from the Ngurah Rai International Airport via new ocean highway

Close to famous sightseeing spots like Ubud and Uluwatu and the pier to visit nearby islands

Relax on Sanur's sandy beach

Hotel guests can enjoy a snooze under the sun on complimentary sun loungers and parasols on golden sandy Sanur beach just a short eight minutes-walk from the hotel. Beach towels is included.

Unique in Bali, Sanur's beach features a 3-kilometer-long promenade including shopping and dining options.

Guests can take an easy stroll along the promenade, rent a bicycle or simply book the free shuttle direct to our beach spot.



Meeting Room Dimensions

The resort has three meeting rooms with natural daylight and a spacious ballroom which can accommodate up to 380 guests for standing reception. From business meetings to product launches to wedding receptions, Sanur Resort Watujimbar is the ideal venue to host your special event in Bali. Before and during the event, our planners will be on hand at all times to assist with arrangements and to ensure that your event is a success. All meeting rooms are fully equipped with modern meeting facilities with state-of-the-art audio-visual equipment

MEETING ROOMS CAPACITY & DIMENSION										
No	Room	Size (M)	Total (SQM)	Ceiling	Capacity					
					Classroom	Theatre	U-Shape	Round Table	Boardroom	Standing Cocktail
1	Zanoor 1	7 x 9	63	2.4 m	22	24	16	18	16	40
2	Zanoor 1A	4.7 x 7.5	35	2.4 m	10	14	6	6	6	15
3	Zanoor 1B	5 x 8.5	42	2.4 m	14	20	12	10	12	25
4	Zanoor 2	11 x 10	110	2.4 m	50	60	18	22	18	75
5	Zanoor 2A	4.7 x 10	47	2.4 m	22	26	16	12	16	35
6	Zanoor 2B	6.5 x 10	65	2.4 m	22	26	16	12	16	35
7	Jimbar Ballroom	13 x 22	286	3.3 m	120	180	78	90	N/A	250
8	Jimbar 1	13 x 10	130	3.3 m	45	70	36	35	N/A	100
9	Jimbar 2	13 x 12	156	3.3 m	55	80	46	45	N/A	150

Meeting Room Rental

Meeting Room	Half Day 8.00 – 13.00 / 13.00 – 18.00	Full Day 8.00 – 18.00
Zanoor 1	2,500,000	3,500,000
Zanoor 2	3,000,000	4,000,000
Ballroom	10,000,000	16,000,000

Above prices are quoted in Indonesian Rupiah and inclusive of 21% service charge and government tax.

Meeting Room Floor Plans

Zanoor 1

- 63 m²
- Natural Daylight

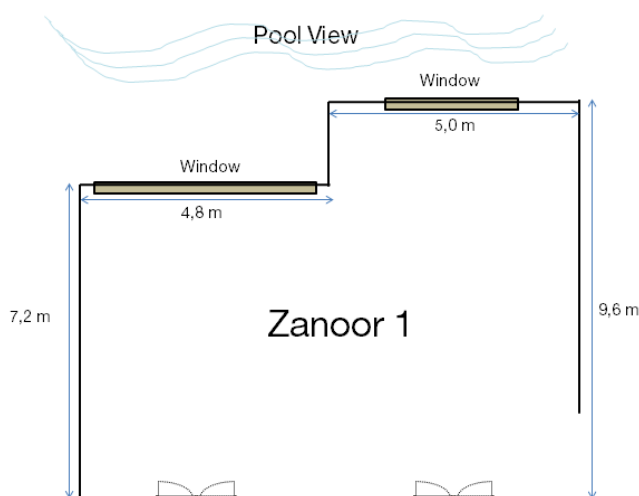

Zanoor 2

- 110 m²
- Natural Daylight

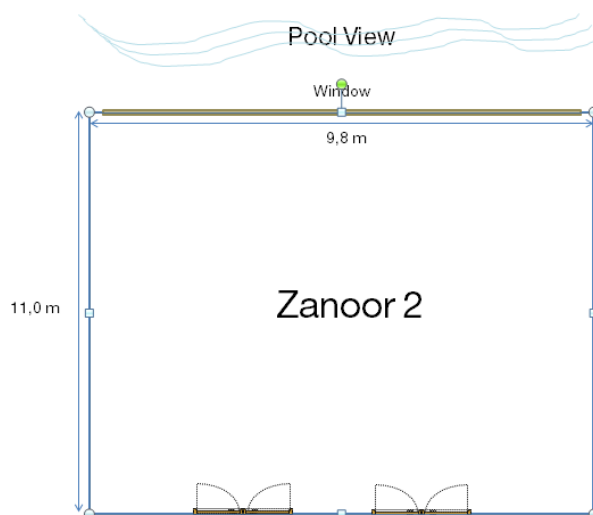

Jimbar Ballroom

- 286 m²
- Reception Area in front of Ballroom

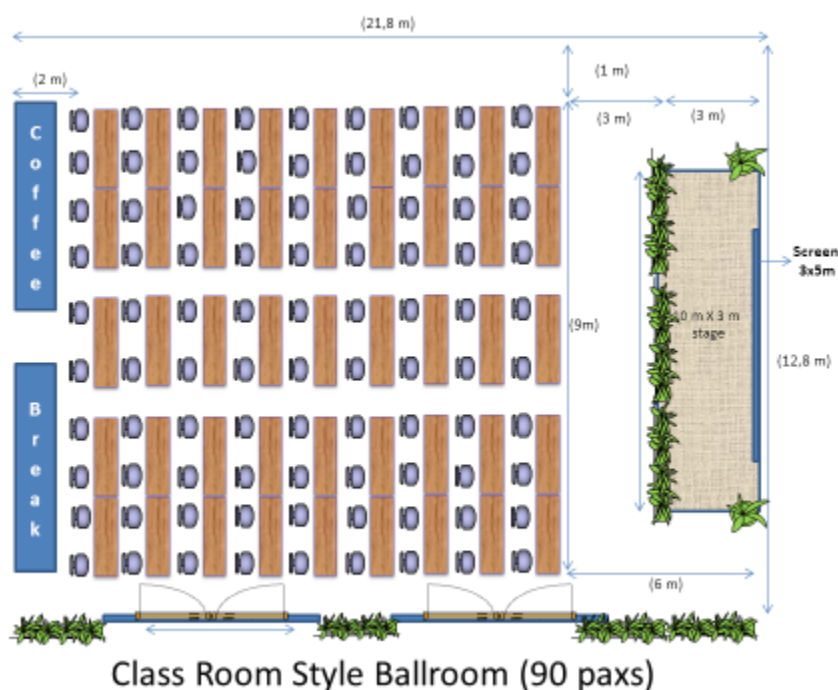

Lunch and Dinner, Buffet and Plated Action (rate per person)

Buffet

Minimum 30 persons or join buffet

Menus available

International, Indonesian, Asian, Western, BBQ.

Set Meal

- ☐ Lite
IDR 300,000 3 courses
- ☐ Complete
IDR 450,000 4 courses
- ☐ Deluxe
IDR 550,000 5 courses

Buffet

- ☐ Lite
IDR 275,000 1 x salad bar, 2 x starter, 1 x soup, 1 x chicken, 1 x seafood, 1 x beef, 1 x vegetable, 1 x starch, 3 x dessert, 1 x assorted sliced fruit
- ☐ Complete
IDR 350,000 1 x salad bar, 3 x starter, 1 x soup, 1 x beef, 1 x chicken, 1 x seafood, 1 x vegetable, 2 x starch, 4 x dessert, 1 x assorted sliced fruit

<input type="checkbox"/> Deluxe IDR 450,000	1 x salad bar, 3 x starter, 2 x soup, 1 x beef, 1 x chicken, 2 x seafood, 1 x vegetable, 3 x starch, 1 x carving station, 4 x dessert, 1 x assorted sliced fruit, 1 x dessert live station
--	--

Above prices are quoted in Indonesian Rupiah and inclusive of 21% service charge and government tax.

Action Stalls (rate per 30 persons)

<input type="checkbox"/> Candy Floss	250,000	<input type="checkbox"/> Ham in Bread	900,000
<input type="checkbox"/> Noodle	900,000	<input type="checkbox"/> Sushi	1,100,000
<input type="checkbox"/> Crepes	1,200,000	<input type="checkbox"/> Chocolate Fountain	1,600,000
<input type="checkbox"/> Seafood tower	3,200,000	<input type="checkbox"/> Gelato	750,000
<input type="checkbox"/> Carving Station	4,500,000	<input type="checkbox"/> Charcoal	3,300,000

Above prices are quoted in Indonesian Rupiah and inclusive of 21% service charge and government tax.



Meeting Package (rate per person)

Description	Lite	Complete	Deluxe
Half Day Meeting Package	300,000	350,000	450,00
1 x Coffee Break, 1 x Lunch or Dinner, Meeting Room and AV equipment			
Full Day Meeting Package	350,000	400,000	500,000
2 x Coffee Break, 1 x Lunch or Dinner, Meeting Room and AV equipment			
Full Board Meeting Package	450,000	550,000	650,000
2 x Coffee Break, 1 x Lunch, 1 x Dinner, Meeting Room and AV equipment			
Residential Meeting Package, Twin Share	950,000		
1 x Breakfast, 2 x Coffee Break, 1 x Lunch, 1 x Dinner, Accommodation on Twin Share Room Basis in a Deluxe Room, Meeting Room and AV equipment			
Residential Meeting Package, Single Room	1,300,000		
1 x Breakfast, 2 x Coffee Break, 1 x Lunch, 1 x Dinner, Accommodation on Single Room Basis in a Deluxe Room, Meeting Room and AV equipment			

All Meeting Packages include:

LCD Projector with Screen
 Standard Sound System
 2 Standing / Wireless Microphones
 Laser Pointer

White Board with Marker
 Flip Chart with Marker
 Stationary (Block Note and Pencil)
 Mineral Water and Candy

Available at charge:

Fax / Photo Copy

Telephone with City Line

Above prices are quoted in Indonesian Rupiah and inclusive of 21% service charge and government tax.

Gala Dinner (rate per person)

Set Meal Minimum 10 persons, maximum 40 persons

Buffet Minimum 25 persons, maximum 120 persons

Menus available Upon Request

Set Meal

☐ Lite
IDR 650,000 5 Course Lunch or Dinner

☐ Complete
IDR 700,000 6 Course Lunch or Dinner

☐ Deluxe
IDR 745,000 7 Course Lunch or Dinner

Buffet

☐ Lite 2 x starter, 1 x soup, 1 x chicken, 1 x seafood, 1 x vegetable, 1 x starch, rice, 2x dessert, 1 x assorted sliced fruit

☐ Complete 1 x salad bar, 2 x starter, 1 x soup, 1 x beef, 1 x chicken, 1 x seafood, 1 x vegetable, 1 x starch, rice, 4 x dessert, 1 x assorted sliced fruit

☐ Deluxe 1 x salad bar, 3 x starter, 2 x soup, 1 x beef, 1 x chicken, 1 x seafood, 1 x vegetable, 1 x starch, 1 x carving station, 4 x dessert, 1 x assorted sliced fruit, 1 x dessert live station

Above prices are quoted in Indonesian Rupiah and inclusive of 21% service charge and government tax.

Beverage (rate per person)

Open Bar, Basic Package	
Soft Drink, Fruit Juice, Sparkling Water, Mocktails	Rate
Open Bar for 1 hour	125,000
Additional hour	85,000
Open Bar, Lite Package	
Soft Drink, Fruit Juice, Sparkling Water, Local Beer, Chips & Nuts	Rate
Open Bar for 1 hour	345,000
Additional hour	285,000
Open Bar, Complete Package (minimum of 30 persons)	
Soft Drink, Fruit Juice, Sparkling Water, Local Beer, House Wine, Chips & Nuts	Rate
Open Bar for 1 hour	685,000
Additional hour	575,000
Open Bar, Deluxe Package (minimum of 30 persons)	
Soft Drink, Fruit Juice, Sparkling Water, Local Beer, House Wine, House Pour Spirit, Chips & Nuts	Rate
Open Bar for 1 hour	570,000
Additional hour	625,000
Corkage Fee	Rate
Wine & Champagne (700ml)	150,000
Spirit	150,000
30L Tank of Beer	1,500,000

Above prices are quoted in Indonesian Rupiah and inclusive of 21% service charge and government tax.

Entertainment

Music	Rate
Full Band , 2 sets of 45 minutes	14,000,000
Accoustic Band , 2 sets of 45 minutes	5,000,000
Duo Electone , 2 sets of 45 minutes	2,500,000
Trio Accoustic , 2 sets of 45 minutes	4,000,000
DJ Perfomance , 2 hours performance	7,000,000
Entertainment Shows	Rate
Fire Dance , performance with 4 dancers, 1 set of 15 minutes	3,000,000
Rindik , A traditional Balinese orchestra played by 2 musicians, 1 set of 45 minutes	1,000, 000
Barong Dance , 5 various dancer performances	3,000,000
Legong Dance , A classical Balinese Cultural Dance which remains the quintessence of femininity and grace, 1 set of 45 minutes	2,500,000
Kecak Dance , A Spine - Tingling nocturnal trance choir dance performed with 25 dancers, 1 set of 45 minutes	3,500,000
Welcome Bali Dance , performance with 4 dancers, 1 set of 7 minutes	1,200,000
Clown , 2 hours entertainment	1,750,000
Cabaret , performance with 6 persons, 1 set of 15 minutes	3,500,000

Above prices are quoted in Indonesian Rupiah and inclusive of 21% service charge and government tax.

Terms and Conditions

ATTENDANCE

It is requested that your Catering & Conference Services Manager be notified with an estimated figure seven (7) days prior to the event(s). The guaranteed final attendance is required by 11:00 a.m., three (3) business days prior to the event or the original attendance will be considered the final guarantee. Final attendance guarantee cannot be decreased within three (3) business days prior to the event. Food and Beverage menu selections cannot be changed within five (5) business days prior to the event. The hotel will overset no more than five percent (5%) over the guarantee for parties up to 300 people.

Should your guaranteed final attendance be significantly less than your original count, the hotel reserves the right to move your event to a more suitable location in order to better serve your guests' space requirements.

AUDIO VISUAL

Sanur Resort Watujimbar has retained AVB to provide a comprehensive range of production services. AVB is a full-service production company with full-time management and staff located on property.

BILLING

For sales groups staying at the hotel, please refer to your Sales Letter of Agreement for payment information.

For catered functions, a fifty percent (50%) non-refundable prepayment is required at the time of contract signing. The balance is due in full, 30 days prior to arrival. This payment can be made in cash, check or cashier's check.

CANCELLATIONS

For sales groups staying at the hotel, please refer to your Sales Letter of Agreement for cancellation policies.

For catered events, should you cancel any time after booking, any expenses incurred by the Hotel in advance preparation for the event will be the responsibility of the guest. Any cancellations received outside of thirty (30) days will be assessed a fee equivalent to fifty percent (50%) of all estimated charges. Any cancellations received within 30 days will be assessed a fee equivalent to the total estimated charges.

DECORATIONS

A full line of theme party props, backdrops, and interactive decorations can be secured through your Catering & Conference Services Manager.

All decorations or displays brought into the hotel must be approved prior to arrival and meet approval of local authorities. In order to preserve the appearance of our public areas and minimize damage, items are not to be attached to any permanent hotel structure, carpet or finishing with nails, staples, tape or any other substance. Subcontractors or vendors may be required to sign acceptance of our published guidelines and procedures before any activity may commence.

Production companies will be required to submit to the Hotel floor plans drawn to scale to include electrical requirements.

ENTERTAINMENT

Sanur Resort Watujimbar has many contacts in the entertainment industry and is able to secure the best local, national and international talents. Please let your Catering & Conference Services Manager know what assistance is required in booking entertainment.

FIRE CODES

When planning and coordinating space and decorations, in the ballroom or meeting rooms, regulations that fall under the local fire authorities must be adhered to. Consult with your Catering & Conference Services Manager for further clarification.

FOOD AND BEVERAGE

Due to health regulations and liabilities, all food and beverage requirements must be contracted with the Sanur Resort Watujimbar. The hotel is responsible for the quality and freshness of the food for all of our guests; therefore, no outside food and beverage may be brought in from another source for consumption in our facilities.

Your final menu selections must be made no later than 45 days prior to your arrival. In the event you do not meet this deadline, be advised that menu prices will be increased by the Resort to reflect the increased cost of obtaining and transporting food to the Resort on short notice.

Plated menu requests at outdoor venues will incur additional surcharges based upon the location. Please consult with your Catering & Conference Services Manager for the appropriate costs involved.

The hotel will provide catering contracts, referred to as Banquet Event Orders at approximately 30 days prior to the program dates. Signed Banquet Event Orders will be required at least 21 days prior to the program dates in order to confirm the arrangements. Special meal requests are easily accommodated. Please advise your Catering & Conference Services Manager.

SECURITY

The Sanur Resort Watujimbar will not assume responsibility for any damage or loss of merchandise or articles brought into the Hotel or any item left unattended in any function area.

WEATHER CALLS

In the event that we are faced with inclement weather on the day your group has booked an outdoor event; a "weather call" is made together between meeting planner and the key operational departments of the hotel. For evening events, these weather calls are made by 12:00 noon. For morning events, calls must be made the night before by 7:00 p.m.

Any weather call made after the time deadlines will be subject to service fees based on the size of the group and the set up required.

Indoor back-up space is always blocked for outdoors events. Please note that open flames are not allowed indoors, therefore, some cooking stations may need to be altered if the event is moved indoors